

ROAD CONSTRUCTION DETAIL SECTION A - A
SCALE 1:50

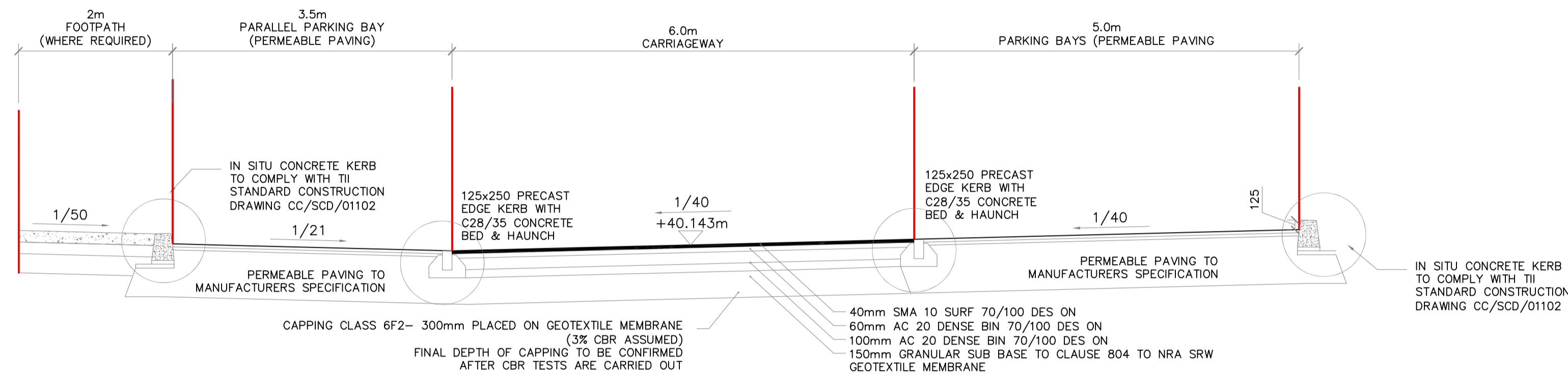

ROAD CONSTRUCTION DETAIL SECTION B - B
SCALE 1:50

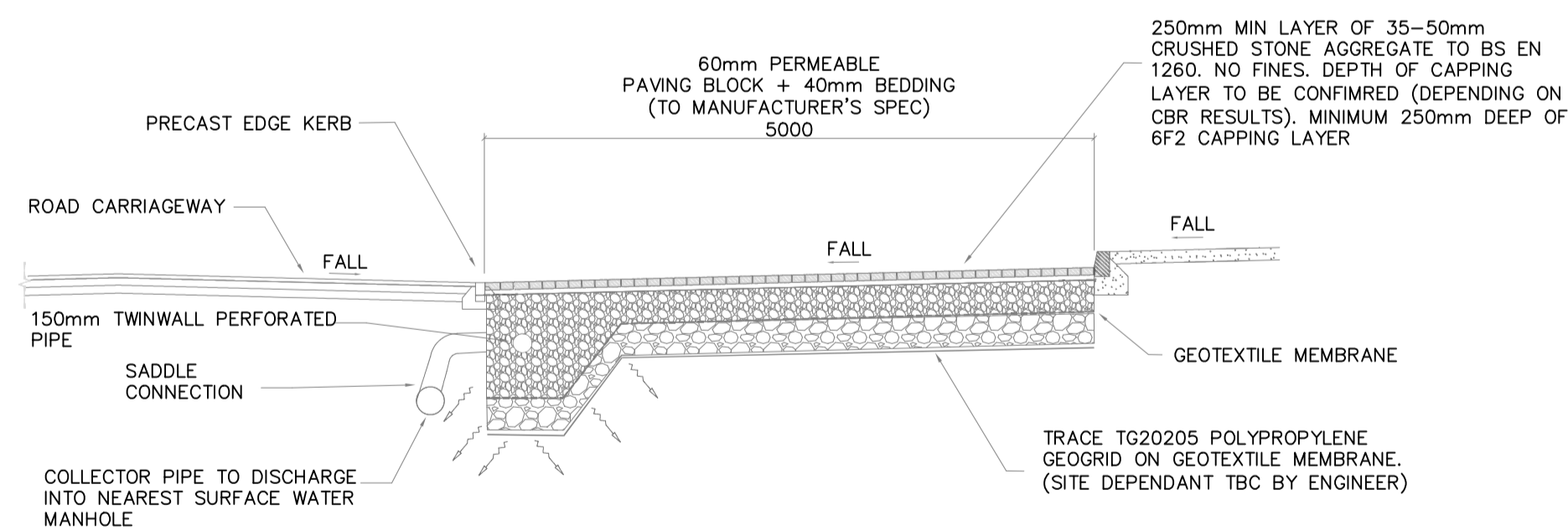

PERMEABLE PAVING CONSTRUCTION DETAIL
SCALE 1:50

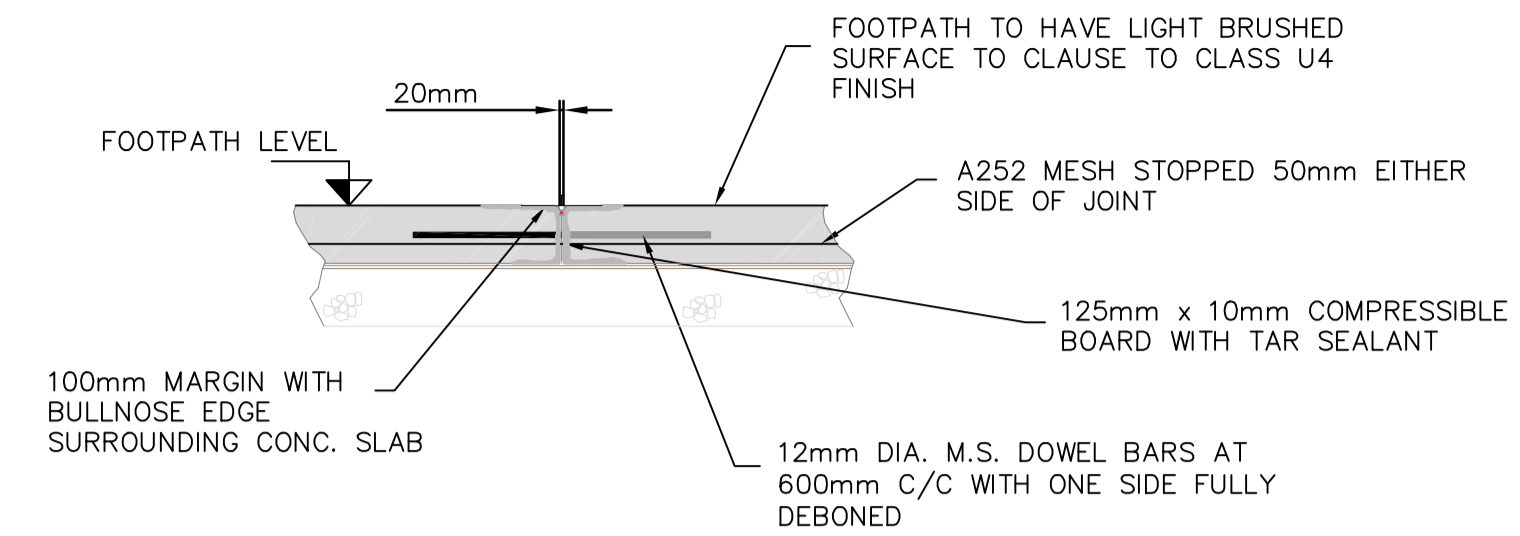

TYPICAL FOTPATH EXPANSION JOINT - MIN. @24m CTRS
SCALE 1:25

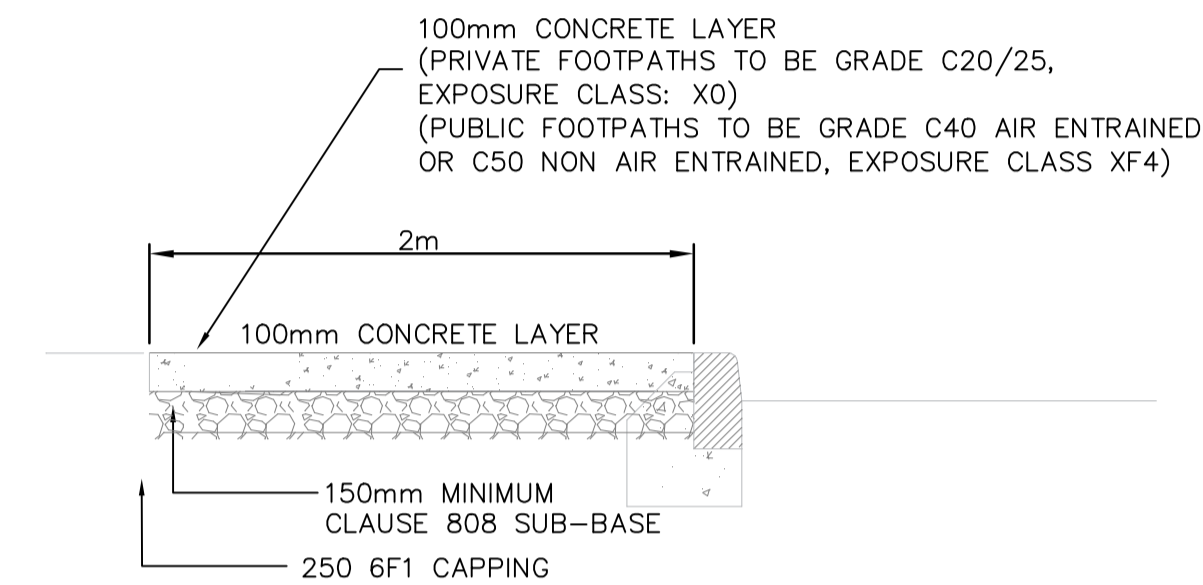

PROPOSED CONCRETE FOOTPATH
SCALE 1:25

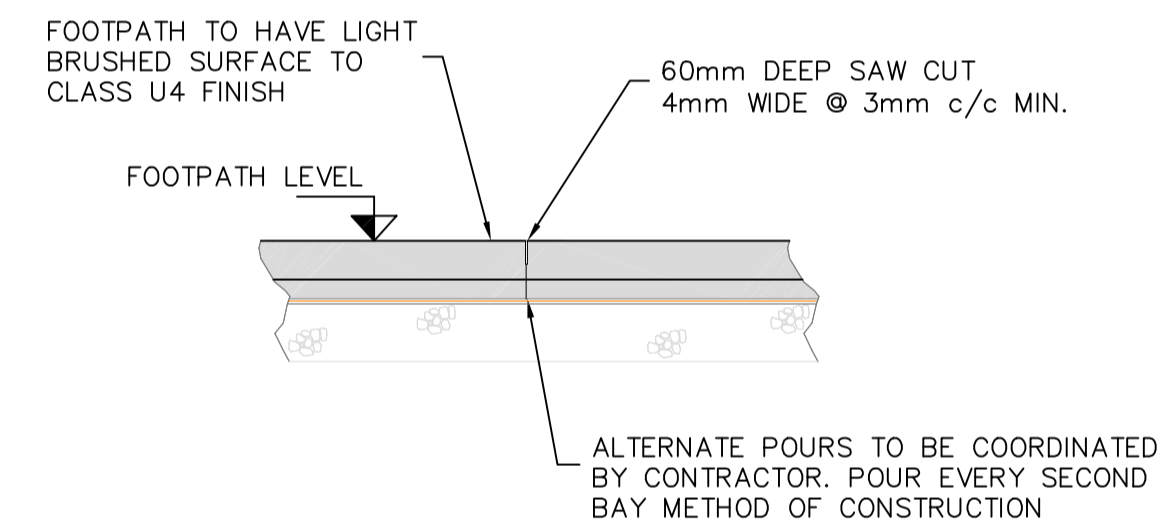

TYPICAL FOTPATH CONSTRUCTION JOINT - MIN. @3m CTRS
SCALE 1:25

issued for
PLANNING

DIMENSIONS

Figured dimensions only to be taken from this drawing. All dimensions to be checked on site. Architects to be informed immediately of any discrepancies before work proceeds.

© COPYRIGHT

This drawing and any design hereon is copyright of JOR Consulting Engineers and must not be reproduced in whole or in part without their express written consent.

REV	DATE	DETAILS
1	23.09.24	Issued for LRD application
0	AUG.24	Draft issue
REV	DATE	DETAILS

jor Joseph O'Reilly
Consulting Civil & Structural Engineers

Tel: 046 9077032 Fax: 046 9077932
Email: mail@jor.ie Web: www.jor.ie

Unit 1, St. Therese's Place, Flowerhill, Navan, Co. Meath

CLIENT	EW Property Ltd	TITLE	LRD: Road Details Sheet 2 of 3
PROJECT	Hartfield Place, Swords Road, Whitehall, Dublin 9, D09 C7F8	SCALE	1:50 @ A1
		DATE CREATED	Sept 24
		DRAWN BY:	DD
		CHECKED BY:	PC
		DRAWING No.	L24-01-LRD-007
		REV	1